

ATKINS

Member of the SNC-Lavalin Group



Welcome!

Welcome to the Autumn issue of the East West Rail Alliance project newsletter.

I wanted to start by thanking everyone who took the time to read and share the last issue of the newsletter. We have seen an increase in the readership of the newsletter and have received feedback on the format with the level of information in the local update sections we introduced in issue two being positive.

As you'll read below, perhaps the most obvious progress we have made since the last newsletter can be seen in Bletchley, where our team has dismantled sections of the Bletchley Flyover ready for it to be rebuilt to modern standards.

The dismantling has demanded a meticulous amount of planning from our team, Network Rail operations, the train operating companies, local authorities and environment agencies and I'm delighted to report all the lifts were safely completed in line with our programme. We are now in the process of removing the final elements of the structure that need to be removed before we can start the rebuild process in November/later this year.

Away from the flyover, we have continued to prepare much of the project footprint for our main construction activities to begin. We have also started work on Charbridge Lane overbridge – one of the most significant construction activities in the East West Rail Phase 2 project. You can read more on this in the content below.

In addition to the challenges Covid-19 presents from an operational perspective, it also presents us with a number of challenges when it comes to keeping residents informed of our progress. This newsletter will therefore become an increasingly important tool as we move through the pandemic, however I am pleased to report that in spite of the challenges, we have continued to engage with key project stakeholders, whether that be via our virtual supply chain engagement events, our socially distanced pop up community engagement event in Bletchley, or working with local charities to help the elderly and vulnerable who have been severely impacted by lockdown restrictions. I am also delighted to welcome our new Community Liaison Advisors, Thaina Sa'id and Vernon Loo, who will play a key role in keeping local communities engaged with the project.

Thank you for your continued interest in the project.

Kind regards

Mark Cuzner, EWR Alliance Director

Enabling works underway



Since the last issue of our newsletter, the Alliance has been preparing many areas across the project footprint for our main construction activities to begin. Highways improvements have been made, with roads widened, passing bays on narrow roads put in place, and access points for our site compounds installed. In addition, we have been constructing 'haul roads', which will enable construction traffic to travel between certain areas of the project without needing to use local roads.

We have also carried out vegetation clearance and drained areas of the old varsity line which have become overgrown and flooded since the line closed in the 1960s. In the Winslow area, in the cutting where the new station will be built, we have been busy installing new drainage, to ensure the line does not flood in future.

As reported in our last newsletter, our archaeology teams have carried out 'strip map and sample' works on a number of sites to ensure there are no archaeologically significant artefacts in the area.

Our Bicester compound is now fully operational, which will be our main compound in the area. This will be the headquarters for our teams in the Bicester area.

We have also started a number of main works activities, in particular, carrying out bridge repairs that need to be made on several existing structures.

Finally, we have begun work on one of the most significant construction activities on the project – the construction of a new road bridge on Charbridge Lane. We have been preparing the site for the construction of a new temporary road which will direct traffic away from the site so the new bridge can be built.

Lift off in Bletchley



A span is lifted from Bletchley Flyover



New Overhead Line Equipment (OLE) is installed



ALO (Any Line Open) protective hoarding is piled and installed

The EWR Alliance has successfully removed 14 spans from the Bletchley Flyover which needed to be dismantled ready for the structure to be rebuilt to modern standards later this year.

The spans previously crossed over the West Coast Mainline and Buckingham Road, and were removed during overnight shifts over consecutive weekends to ensure the West Coast Main Line could remain operational throughout.

The complex lifts have been carried out with the help of three of the largest mobile cranes in the UK - the largest capable of lifting 1200 tonnes! Once the spans were removed from the structure, they were taken to the Alliance compound off Water Eaton Road where they were crushed, with the majority of the stone set to be re-used elsewhere on the project.

With the spans now removed, the team move onto removing the remaining 'piers' which held the spans in place. These will be lifted over similar overnight weekend possessions, following which the process of rebuilding will start in November/later this year.

We are sorry that some of our works in Bletchley have had an unavoidable impact on local residents, particularly those in close proximity to the flyover, with overnight piling works taking place over the weekends and some in the midweek. It is essential we carry out these piling works to erect ALO (Any Line Open) hoardings which are needed to allow our teams safe access to the flyover to complete the rebuild whilst the railway remains open. This overnight piling activity will be complete in November and will mean we no longer need as many weekend overnight possessions. This will speed up the construction and mean less inconvenience for local residents.



To complete the work on the flyover, it has been necessary to close Buckingham Road to road traffic. The current road closure will be in place until early December. During this time a diversion will remain in operation, however pedestrian access has been maintained. On occasions where this has not been possible, the Alliance has provided a free shuttle bus to escort pedestrians around the diversion.

To read more about upcoming works in Bletchley, please refer to the Bletchley section of the local updates below.

Left: one of the spans is transported from Buckingham Road to Water Eaton Road

Introducing our new Community Liaison Advisors



Since the last issue of our newsletter, we have recruited two dedicated Community Liaison Advisors who will be responsible for engaging with key stakeholders, including members of the public across the project to keep you up to date on our progress and respond to your queries and feedback.

Vernon Loo will be covering the area between Bletchley and Little Horwood, including Newton Longville, Swanbourne, Winslow, and Mursley. Thaina Sa'id will be responsible for the areas between Bicester and Verney Junction, including Launton, Stratton Audley, Poundon, Marsh gibbon, Charndon, Twyford, Edgcott, Calvert, Steeple and Middle Claydon.

The easiest way to get in touch with the team should you have any queries or feedback would be to email us at publicinformation@ewralliance.co.uk, or contact us via the 24/7 Network Rail helpline on 03457 11 41 41 or www.networkrail.co.uk/contactus.

Pop up community engagement event held in Bletchley



When lockdown measures were introduced in March 2020, our plans for hosting regular community engagement events were naturally put on hold. However, we believe it is vital for us to engage with the communities in which we are working to help keep local residents and businesses up to date and informed about project progress and so we are visible and approachable as a team.

In late September, the Alliance held two trial pop up community engagement events near our Bletchley site. The team erected a gazebo behind the site barriers at the top of Buckingham Road, with members of the team available between the hours of 10am and 3pm on Tuesday and 3pm and 7pm on Thursday to talk to members of the public about the project.

Clearly, all social distancing measures were followed at all times, with members of the public standing on markers a safe distance from the project team, and only a certain number of people allowed into the area at any one time.

Jeff Booth, Project Leader for our Bletchley works said: “the trial event was a great success and it was really beneficial for us and the people that visited us to talk directly with the team to find out more about the works. We spoke to around 30-40 people on each day and it was great to see so many people interested to learn more about what it is we’re doing.”

We will carry out further events as soon as restrictions permit us to do so, as we are aware people appreciate a face to face chat to discuss the project.

In the meantime, if you’d like to talk to us directly please contact our Community Liaison Advisors Vernon or Thaina at publicinformation@ewralliance.co.uk

Virtual supply chain engagement held

On Wednesday 7 October, the Alliance hosted an online supply chain engagement event aimed at existing supply chain partners as well as prospective suppliers who may be interested in working with the Alliance.

The event was promoted via the Alliance’s [CompeteFor procurement portal](#), and via Buckinghamshire Business First, and with over 200 registrations for the event from 177 different companies, it’s clear there is a lot of interest in the project from across the supply chain.

The event was a chance to bring suppliers up to speed with the status of the project and the progress that has been made and to provide some information on the opportunities that will be available through the project, and share details on our procurement and onboarding processes.

The Procurement & Commercial teams will be hosting similar supply chain engagement events on a quarterly basis.

If you are interested to learn how your business may be able to get involved in the project, be sure to [visit our CompeteFor portal](#) and sign up for alerts. You can also contact the procurement team via email at procurement@ewralliance.co.uk.

Alliance lends a helping hand in community gardening project

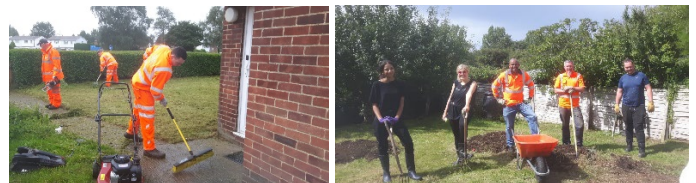

Over the summer, 20 members of the Alliance team took part in a number of voluntary gardening projects organised by local charity, Community Impact Bucks.

The teams visited elderly and vulnerable residents - many of whom had been severely impacted by coronavirus lockdown restrictions - to lend a helping hand in their gardens – observing social distancing measures at all times.

Samantha Hardy, from Community Impact Bucks said: “We are extremely grateful to East West Rail Alliance for providing us with 23 of your team members to assist us on our Gardening and Befriending project. Over the 4 days the Alliance team tackled 10 overgrown gardens in Aylesbury, Waddesdon, Quanton and Steeple Claydon which benefited 16 vulnerable elderly/disabled residents.

“The Alliance’s offer of help could not have come at a better time for us and our clients because we were behind on our gardening visits due to the COVID-19 Pandemic. The team’s hard work has really helped towards getting us back on track.”

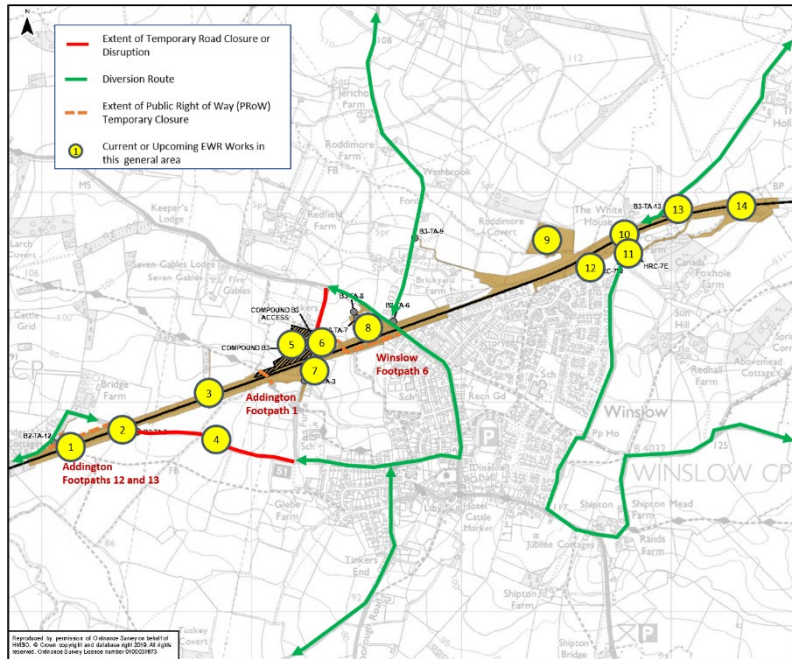

Winslow

1. Cattle Arch underbridge repairs

Description: We will refurbish the existing bridge. Work will include new waterproofing, brickwork repairs, installing new parapets, deck repairs and new handrails.

Duration: Work started in spring 2020 with site clearance and construction of scaffolding. Work will continue until spring 2021.

Disruption: The footpath under the bridge will be closed for the duration of the work.

Recent progress: We have carried out the brickwork repairs to the structure and are now repairing the existing concrete deck.

Upcoming Activity: We will complete repairs to the structure in autumn 2020.

2. Verney Road underbridge repairs

Description: We are strengthening and upgrading the existing bridge to support the new railway. Work will include brickwork repairs, installing new parapets, handrails, walkways and deck waterproofing.

Duration: Site clearance was completed in spring this year,

and repairs started in the summer. The repair works are due for completion in Spring 2021.

Disruption: From summer until late 2020 there will be several road closures and/or traffic management in place on Verney Road. All closures will be published on [one.network](#) and appropriate signage displayed.

Recent progress: We have carried out the brickwork repairs to the structure and are now repairing the existing concrete deck.

Upcoming Activity: We will complete repairs to the structure in autumn 2020.

3. Cattle Arch overbridge repairs

Description: The existing bridge will be strengthened and upgraded to support the new railway. Work will include brickwork repairs, installing new parapets, handrails and walkway, as well as a deck repair and waterproofing.

Duration: The work will start in autumn 2020 with site clearance and construction of scaffolding. The work is due for completion in the summer of 2021.

Disruption: The footpath under the bridge will be closed for the duration of the repair works.

Upcoming Activity: Site clearance and construction preparation works begin in autumn 2020.

Recent progress: We have started to remove existing materials from the bridge, to enable the repair work to start.

4. Highways improvements - passing bays and junction improvements

Description: We will carry out junction improvements and road widening to allow construction traffic to keep to the agreed construction traffic routes on main roads and minimise traffic using local public roads.

Duration: The improvement works will begin in autumn 2020 and are due for completion in late autumn/early winter 2020.

Disruption: There will be partial road closures in place during the construction works. These will be publicised on [one.network](#) and appropriate signage will be displayed in advance of the closures.

Upcoming Activity: Partial road closures for the construction of new road widening works will continue in autumn/winter 2020.

5. Furze Lane, Winslow Compound construction

Description: We will build a compound to provide site offices, staff welfare and material storage for the duration of our construction works in the area. This compound will also provide an access route to the new railway construction site to minimise the amount of construction vehicles using local roads.

Duration: The construction of the compound is underway and once complete it will be used until our construction activities have finished in the summer of 2022. The land where the compound lies will then be reinstated to its former condition.

Disruption: There will be partial and full road closures of Furze Lane as the compound access route is constructed. There will also be increased construction traffic using the compound for the duration of the work. Access to Furze Lane for residents, businesses and the Burial Grounds will be maintained at all times.

Recent progress: Since the last issue of the newsletter, we have put protection in place for the existing utilities that are found in the compound site. In addition, we have started to prepare the site for the construction of the compound by carrying out earthworks and drainage works.

Upcoming Activity: The construction of the compound will be complete in autumn 2020.

6. Furze Lane, Winslow Compound access and highway improvement

Description: A new access road off Furze Lane into the new compound will be constructed. We will also be carrying out road widening works along Furze Lane from the junction with Buckingham Road.

Duration: The access and improvements work began in June 2020 and will continue into autumn 2020.

Disruption: Roadworks will remain in place whilst the works are completed and there will be partial road closures of Furze Lane throughout the highway improvements in autumn 2020. All closures will be publicised on [one.network](#) and appropriate signage will be displayed. Access to Furze Lane for residents, businesses and the Burial Grounds will be maintained at all times.

Upcoming Activity: The construction of the compound due to be complete in late autumn 2020.

7. Furze Lane Bridge

Description: We will upgrade the existing Furze Lane bridge so that it can support the new railway. Works will include brickwork repairs and deck waterproofing.

Duration: The upgrade work is due to start in the spring of 2022 and is due for completion in the winter of 2022.

Disruption: There will be several road closures and/or traffic management in place on Furze Lane while the repair work is carried out. All closures will be publicised on [one.network](#) and appropriate signage will be displayed. Access to Furze Lane for residents, businesses and the Burial Grounds will be maintained at all times.

Upcoming Activity: These works will not begin until 2022.

8. Winslow Station construction

Description: One of the most significant activities to take place in phase two of East West Rail is the construction of a brand-new station in Winslow, providing access to the new East West Rail line for local residents. The station will include two new platforms which will be located in the cutting of the old railway line. These platforms will be accessed via new lifts and staircases, with a new footbridge providing access over the railway to the platform on the far side of the cutting.

Duration: Construction work will begin in summer 2020 and is due for completion in the Summer of 2023.

Disruption: There will be an increased level of construction traffic along agreed HGV routes in the local area to help aid the construction of the new station. This will be minimised as much as possible by utilising the access point at our compound off Furze Lane, which will provide an access point for vehicles that need to access to the low-level works within the railway cutting. The existing footbridge over the cutting will also be closed, to enable its demolition.

Recent progress: We have completed vegetation clearance works in the cutting and are installing the new drainage system to dewater the area where the new platforms will be. In addition, we have demolished the existing footbridge and removed its foundations.

Upcoming Activity: Over the autumn and winter, we will complete the installation of the new drainage system, and will then continue with earthworks in the cutting.

9. Environmental Compensation Site

These sites have been established to mitigate our impact on the local ecology. They include the creation of aquatic habitat features like river back waters, grasslands, scrub and woodland with specific species and features for badger, otter, reptiles, great crested newts, bats, butterflies etc.

10. Horwood Road underbridge repairs

Description: The existing Horwood Road underbridge deck will be demolished and replaced with a new bridge to support the new railway.

Duration: We completed some preparation works in April 2020. The next phase began in the summer of 2020 and is due for completion in the spring of 2021.

Disruption: A road closure of Little Horwood Road will be required to complete the repair work. The road closure is due to start in late summer/early autumn 2020 and will be in place until early 2021. This road closure will be coordinated with other works in the area to minimise disruption to the local road networks. The closure will be publicised on [one.network](#) and appropriate signage will be displayed.

Recent progress: We have completed clearance works around the bridge and formed a temporary access for our teams to use. In addition, we have constructed passing bays along Horwood Road.

Upcoming Activity: The demolition of the existing bridge deck will start in autumn 2020, followed by the installation of a new bridge structure in the winter.

11. Site access construction

Description: We will build a site access point and ramp to provide access to the railway line for our construction vehicles – reducing the need for these vehicles to use local roads.

Duration: The work took place over the summer of 2020 and will be completed in autumn 2020.

Disruption: There will be partial road closures to complete these works. However, once complete this access point will reduce the amount of construction traffic on the local road networks. All closures will be publicised via [one.network](#) and appropriate signage will be displayed.

Upcoming Activity: The construction of this access point is due to complete in autumn 2020.

12. Haul road construction

Description: We are constructing a new haul road in this area for our construction traffic to use in order to minimise our use of public highways

Duration: Work began early summer and the haul road will be constructed by autumn 2020.

Disruption: There will be an increase in construction traffic throughout the work to establish the haul road.

Recent progress: We have installed the hoarding which will line the route of the haul road and construction of the haul road itself is in progress.

Upcoming Activity: Haul road construction will be completed in autumn 2020.

13. Maintenance Access Construction

Description: A permanent maintenance facility will be constructed to provide the new railway operator's maintenance teams access to the new railway equipment once the new line opens.

Duration: Construction will begin in the summer of 2022 and is due for completion in early 2023.

Disruption: There will be partial road closures as the access point is constructed. These closures will be publicised on [one.network](#) and appropriate signage displayed.

Upcoming Activity: There will be no construction activity for this compound until 2022.

14. Horwood Brook underbridge repairs

Description: Horwood Brook crosses under the railway in two locations at railway bridges 'OXD 15' and 'OXD 17'. We will be upgrading both bridges to support the new railway. The upgrades will include brickwork repairs and strengthening works.

Duration: Bridge repairs started in the summer of 2020 and works are due for completion in late summer 2021.

Disruption: There will be minimal disruption during these works as access to the bridges is provided via the construction traffic haul roads that we are building away from the public highways to minimise disruption on local roads.

Recent progress: Site clearance works have been carried out at each bridge. Brickwork repairs have been undertaken to OXD15, and repairs and strengthening of the existing concrete bridge deck are now taking place.

Upcoming Activity: Brickwork repairs will start on bridge OXD 17 in autumn 2020, and repairs and strengthening works to OXD15 will be completed.

More Information

This newsletter has been published as a summary of works in the Winslow area. If you would like more information on the entire East West Rail Phase Two project, scan the QR Code opposite to read our project-wide newsletter.

